

MONTANA HISTORICAL AND ARCHITECTURAL INVENTORY

Site #



Legal Description: Block 48, Lots 2 & 3, Roundup Second Addition

Address: 415 Third Street West (rear)

Ownership: name: James E. Langan

private public address: 1202 First Street East, Roundup, Mt.

Roll # A12 Frame # 10

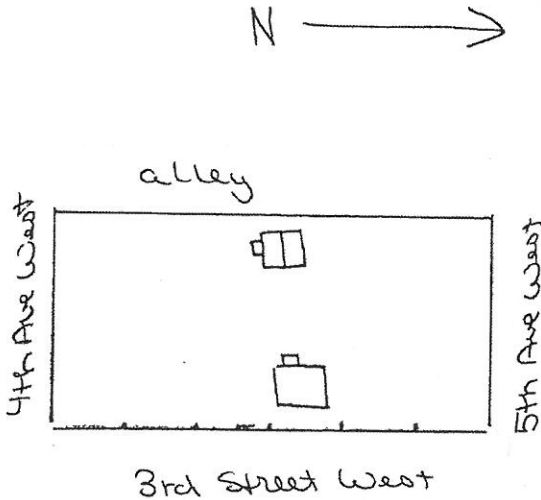

Location map or building plan with arrow north.

Historic Name: _____

Common Name: _____

Date of Construction: 1925 estimated documented

Architect: _____

Builder: _____

Original Owner: Bridgie Busch

Original Use: Residence

Present Use: Storage

Research Sources:

<input type="checkbox"/> abstract of title	<input type="checkbox"/> city directories
<input type="checkbox"/> plat records/maps	<input type="checkbox"/> sewer/water permits
<input checked="" type="checkbox"/> tax cards	<input type="checkbox"/> obituaries
<input type="checkbox"/> building permit	<input type="checkbox"/> biographies
<input checked="" type="checkbox"/> Sanborn maps — dates: 1912, 1920, after 1920	

Bibliography: Area not mapped 1912

Interview:
James Langan August 29, 1983
Chain of Ownership Cards, Clerk and Recorder's Office

PHYSICAL DESCRIPTION: Describe present appearance of structure/site, then contrast and compare that with it's original appearance, noting additions, alterations, and changes in materials. Discuss significant architectural features.

This is a ^{tall, square} one and one-half story wood frame structure with gable roof. Other features include exterior brick chimney, enclosed eaves, wood roof shingles, wood horizontal overlap siding, double-hung windows (boarded up) wood and glass panel door (glass gone and boarded up) rectangular (boarded up) gable windows, and a cement foundation.

In the interior, the sleeping room is in the upper one-half story, the parlor is on the main floor, and the kitchen and dining area is in the basement.

This is a contributing structure.

HISTORICAL SIGNIFICANCE: Justify how the persons, important events, and/or historical patterns associated with the structure/site and surrounding area lend the property significance.

INTEGRITY: Assess the degree to which the structure/site, and surrounding area accurately convey the historical associations of the property.

This is a residential neighborhood of large attractive, mostly unremodeled homes. This small house is a little out of place here and somewhat weatherworn. It has excellent integrity of materials (overlap siding wood shingles) design (sleeping, parlor, kitchen) and craftsmanship.

INFORMATION VALUE: Explain how the extant structure/site may demonstrate or yield information about its historic use or construction.

FORM PREPARED BY:

Name: Elizabeth Wood

Address: Box 12, Roundup, Mt.

Date: August 10, 1983

GEOGRAPHICAL INFORMATION:

Acreage: Less than one acre.

USGS Quad: Roundup, Mt.

UTM's: