

MONTANA HISTORICAL AND ARCHITECTURAL INVENTORY

Site #



Legal Description: Block 19, Lots 5 & 6, Northwest Townsite 2nd Addition

Address: 410 4th St. West

Ownership: name: Alvin E. & Helen R. Mock

private address: 410 4th Street West, Roundup, Mt.
 public

Roll # A12 Frame # 17

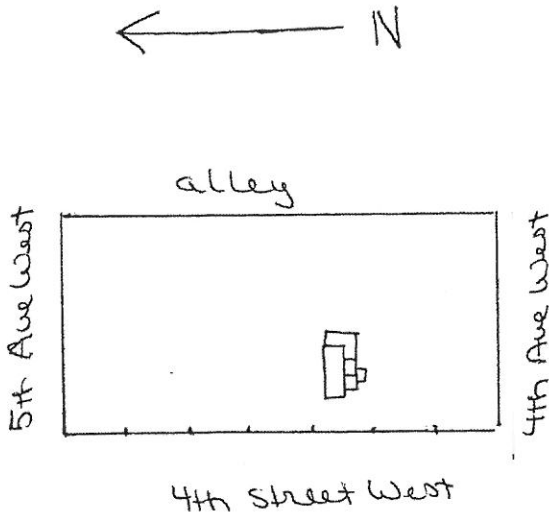

Location map or building plan with arrow north.

Historic Name: _____

Common Name: _____

Date of Construction: Addition 1973 estimated documented

Architect: _____

Builder: _____

Original Owner: _____

Original Use: _____

Present Use: _____

Research Sources:

- abstract of title
- plat records/maps
- tax cards 1973
- building permit
- Sanborn maps -- dates: _____
- city directories
- sewer/water permits
- obituaries
- biographies

Bibliography: _____

PHYSICAL DESCRIPTION: Describe present appearance of structure/site, then contrast and compare that with it's original appearance, noting additions, alterations, and changes in materials. Discuss significant architectural features.

This is a round roofed metal trailer with a wood-frame gable roof, a large room addition and a rear shed roof car port. The gable roof addition has vertical wood board siding, 6-light aluminum frame windows, 3-light wood-frame windows, cement foundation, and a fiberglass entry awning. The rear car port is a corrugated fiberglass cover.

This is a neutral structure.

HISTORICAL SIGNIFICANCE: Justify how the persons, important events, and/or historical patterns associated with the structure/site and surrounding area lend the property significance.

INTEGRITY: Assess the degree to which the structure/site, and surrounding area accurately convey the historical associations of the property.

This mobile home residence is located on a block of mostly remodeled older homes. Although the mobile home part is not compatible with an historic district, the additional structure built along it partially obscures the mobile home. The modern windows and siding on the structure make it a neutral residence.

INFORMATION VALUE: Explain how the extant structure/site may demonstrate or yield information about its historic use or construction.

FORM PREPARED BY:

Name: Elizabeth Wood

Address: Box 12, Roundup, Mt.

Date: August 9, 1983

GEOGRAPHICAL INFORMATION:

Acreage: Less than one acre.

USGS Quad: Roundup, Mt.

UTM's: