

MONTANA HISTORICAL AND ARCHITECTURAL INVENTORY

Site #



Legal Description: Block 3, E 50' of *, all of 9, Steen Addition

Address: 408 Seventh Street West

Ownership: name: Leroy Newton

private
 public address: Box 84, Roundup, Mt.

Roll # A13 Frame # 13

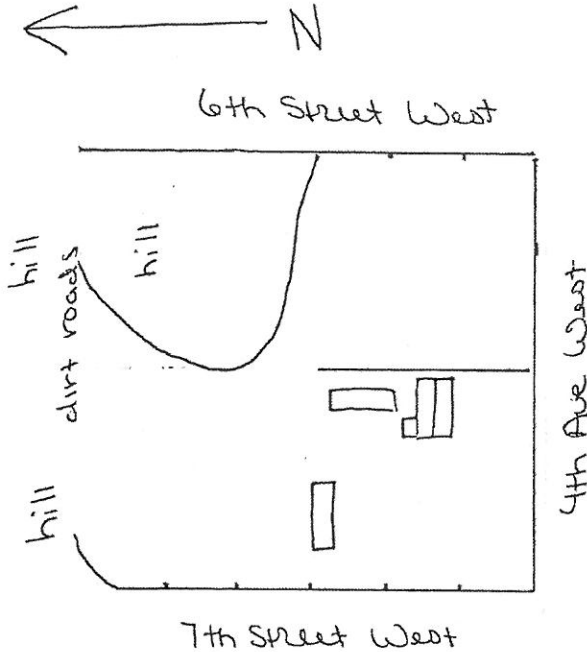

Location map or building plan with arrow north.

Historic Name: _____

Common Name: _____

Date of Construction: 1920 Moved in approx. 1940 estimated documented

Architect: _____

Builder: _____

Original Owner: Frank Maholovich (this site)

Original Use: Garage

Present Use: Garage

Research Sources:

- abstract of title
- plat records/maps
- tax cards
- building permit
- Sanborn maps — dates: _____
- city directories
- sewer/water permits
- obituaries
- biographies

Bibliography:

Interview: Mrs. Frances Newton July 21, 83
Chain of Ownership cards, Clerk and Recorder's Office

PHYSICAL DESCRIPTION: Describe present appearance of structure/site, then contrast and compare that with it's original appearance, noting additions, alterations, and changes in materials. Discuss significant architectural features.

This tall one-story wood frame rectangular garage has gable roof and a low shed roof attachment to the north. Other features include wood roof shingles, beveled edge wood siding with corner boards, casement hung bevel edged wood garage doors, 2/2 double-hung south windows and no visible foundation. There is a new cement block exterior chimney.

This is a contributing structure.

HISTORICAL SIGNIFICANCE: Justify how the persons, important events, and/or historical patterns associated with the structure/site and surrounding area lend the property significance.

INTEGRITY: Assess the degree to which the structure/site, and surrounding area accurately convey the historical associations of the property.

This garage, flooded out in Klein, is now located in a working class neighborhood of mixed old and remodeled buildings. Moving has caused loss of integrity of location, but the building still retains good integrity of materials, design, and craftsmanship.

INFORMATION VALUE: Explain how the extant structure/site may demonstrate or yield information about its historic use or construction.

FORM PREPARED BY:

Name: Elizabeth Wood
Address: Box 12, Roundup, Mt.
Date: July 21, 1983

GEOGRAPHICAL INFORMATION:

Acreage: Less than one acre.
USGS Quad: Roundup, Mt.
UTM's: _____