

MONTANA HISTORICAL AND ARCHITECTURAL INVENTORY

Site # _____



Legal Description: Block 2 Lot 23 and 24 Nelson Second Addition

Address: 343 First Avenue West

Ownership: name: Michael E. and Phoebe A. Graham

private address: 209 Second Street West Roundup, MT.

public

Roll # A3 Frame # 32

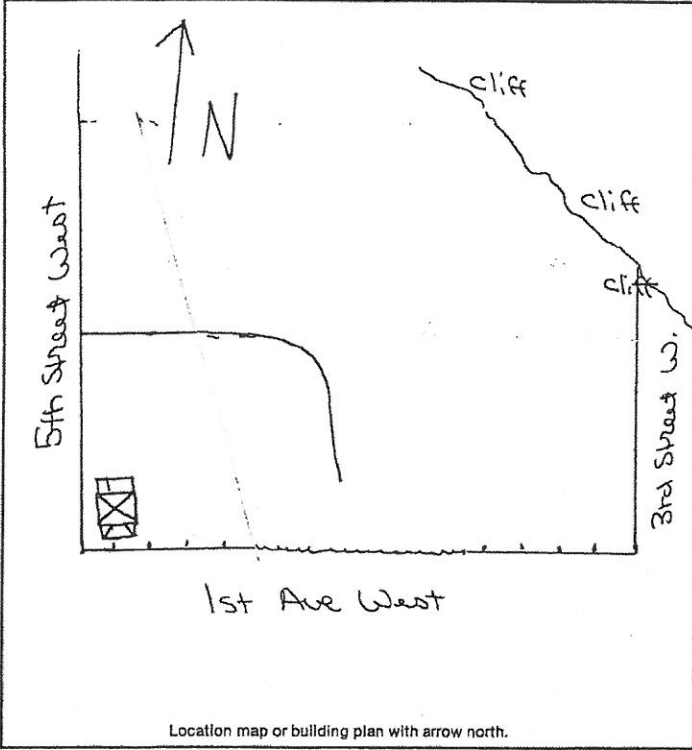

Location map or building plan with arrow north.

Historic Name: _____

Common Name: _____

Date of Construction: 1910 1976 remodeled estimated documented

Architect: _____

Builder: Albert Schroeder

Original Owner: Albert Schroeder

Original Use: residence

Present Use: residence-vacant

Research Sources:

abstract of title city directories

plat records/maps sewer/water permits

tax cards obituaries

building permit biographies

Sanborn maps - dates: 1912, 1920, Before 1920

Bibliography: area not included in 1912 map

Interview: Mrs. William Glancy 9/27/83
Chain of Ownership cards, Clerk and Recorder's Office

PHYSICAL DESCRIPTION: Describe present appearance of structure/site, then contrast and compare that with it's original appearance, noting additions, alterations, and changes in materials. Discuss significant architectural features.

This square one story wood frame residence has a clipped pyramid hip roof, a hip roof 7/8 front porch and a shed roof rear addition. Other features include, wood roof shingles, a stretcher bond brick interior chimney, enclosed elongated eaves 1/1 double hung windows, beveled edge horizontal siding with corner boards. The enclosed front porch has row 1/1 double hung windows and square lattice wood work under the porch. There is a cement foundation. Modern materials include 1/1 double hung windows in wood surround, and board and batten siding in the rear addition.

This is a contributing structure.

HISTORICAL SIGNIFICANCE: Justify how the persons, important events, and/or historical patterns associated with the structure/site and surrounding area lend the property significance.

Albert Schroeder was an early builder in Roundup. Later he went into business with Dozois in the Condon Store (men's wear) and real estate. He was an alderman for the city 1916-18. He owned this property from 1918-1920.

Sources: Polk City Directories
Interview: Vic Fink

INTEGRITY: Assess the degree to which the structure/site, and surrounding area accurately convey the historical associations of the property.

This is a busy commercial thoroughfare with mixed old and new structures. This sturdy railroad style house has been thru several severe floods. The original design and materials are still apparent but deterioration has affected the integrity of the building. The modern shed added to the rear affects the original integrity only slightly.

INFORMATION VALUE: Explain how the extant structure/site may demonstrate or yield information about its historic use or construction.

FORM PREPARED BY:

Name: Elizabeth Wood
Address: Box 12 Roundup, MT.
Date: July 11, 1983

GEOGRAPHICAL INFORMATION:

Acreage: less than 1 acre
USGS Quad: Roundup
UTM's: _____