

MONTANA HISTORICAL AND ARCHITECTURAL INVENTORY

Site #



Legal Description: Block 49, Lot 1, Roundup Second Addition

Address: 323 Third Street West

Ownership: name: Lawrence K. Todd

private address: Boc 855, Roundup, MT
 public

Roll # B3

Frame # 27

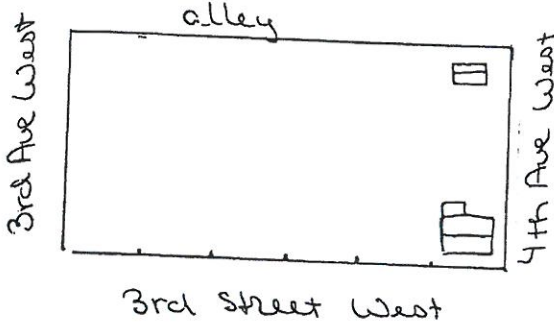

Location map or building plan with arrow north.

Historic Name: _____

Common Name: Moved to site

Date of Construction: 1910 after 1920 estimated documented

Architect: _____

BUILDER: _____

Original Owner: Alex Gritz

Original Use: residence

Present Use: residence

Research Sources:

- abstract of title
- plat records/maps
- tax cards 1930
- building permit
- Sanborn maps — dates: 1920; after 1920
- city directories
- sewer/water permits
- obituaries
- biographies

Bibliography:

Interview: Lawrence Todd
July 15, 1983
 Chain of Ownership cards, Clerk and Recorder's Office

PHYSICAL DESCRIPTION: Describe present appearance of structure/site, then contrast and compare that with its original appearance, noting additions, alterations, and changes in materials. Discuss significant architectural features.

A one-story ell-shaped wood-frame residence with gabled roof, extending eaves, with fascia, recessed front porch and rear gable roof extension and concrete foundation. Building has corbeled T-shape brick chimney, wood shingles, clapboard siding, and rafters under the eaves. Front porch is open under eave extension with square posts on clapboard railing (apron). Bottom of front porch has lattice work. Front and side of building has large fixed wood frame windows. Most other windows are wood frame, double-hung 1/1 with wood-surround trim and drip board and sill. Front door is wood with diagonal lights, wood frame and wood surround trim.

Cement block garage with gable roof, wood shingles and two upward sliding garage doors with multi-panels and lights is located at rear of property.

This is a contributing structure.

HISTORICAL SIGNIFICANCE: Justify how the persons, important events, and/or historical patterns associated with the structure/site and surrounding area lend the property significance.

INTEGRITY: Assess the degree to which the structure/site, and surrounding area accurately convey the historical associations of the property.

This residence is located in a block of other, older residences of comparable scale. It possesses integrity of setting, design, materials and workmanship, and conveys a clear sense of the property's historical associations even though it was moved to this site.

INFORMATION VALUE: Explain how the extant structure/site may demonstrate or yield information about its historic use or construction.

FORM PREPARED BY:

Name: William Babcock

Address: 2920 Salish Court, Missoula, MT

Date: July 15, 1983

GEOGRAPHICAL INFORMATION:

Acreage: less than one acre

USGS Quad: Roundup, MT

UTM's: _____