

# MONTANA HISTORICAL AND ARCHITECTURAL INVENTORY

Site # \_\_\_\_\_

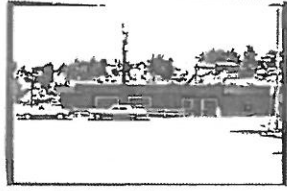

Legal Description: Block 2, Lots 29 - 38, Nelson's 2nd Addition

Address: 317 1st Ave. West

Ownership: name: Mark H. Petrie

private address: 520 3rd St. West, Roundup, Mt.

Roll # A3 Frame # 35

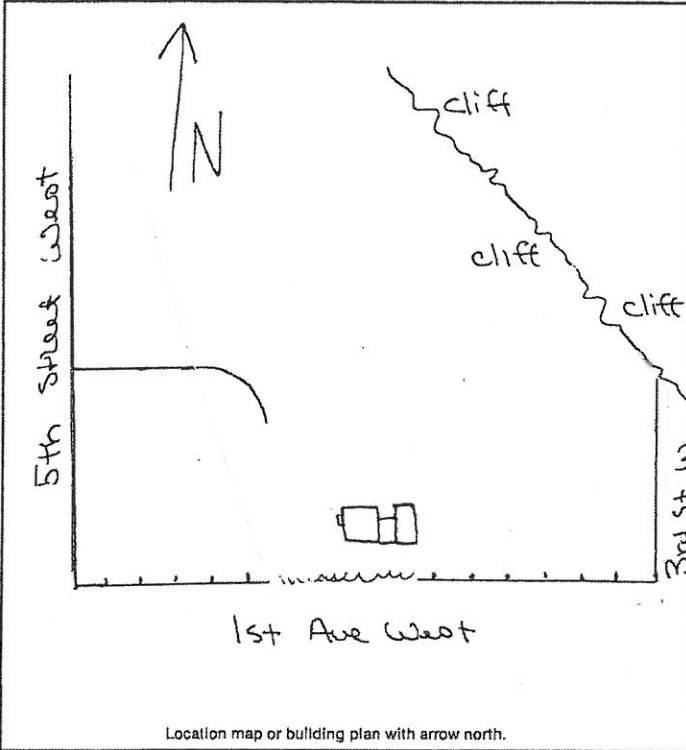

Location map or building plan with arrow north.

Historic Name: \_\_\_\_\_

Common Name: Busy Bee Cafe moved from \_\_\_\_\_

Date of Construction: 1910 country 1920's -  estimated  documented  
remodeled, 1972

Architect: \_\_\_\_\_

Builder: \_\_\_\_\_

Original Owner: \_\_\_\_\_

Original Use: dress shop/cafe

Present Use: restaurant

Research Sources:

- abstract of title
- plat records/maps
- tax cards 1930 Remodeled
- building permit 1972
- Sanborn maps - dates: 1912, 1920; after 1920
- city directories
- sewer/water permits
- obituaries
- biographies

Bibliography:

Interview: Mary Ann Petrie 10/3/83  
Chain of Ownership cards, Clerk and Recorder's Office

**PHYSICAL DESCRIPTION:** Describe present appearance of structure/site, then contrast and compare that with it's original appearance, noting additions, alterations, and changes in materials. Discuss significant architectural features.

This modern flat roof rectangular commercial building has a small enclosed western entryway. Other features include: enlarged, enclosed box eaves with vertical wood paneling on them, fixed long rectangular windows in wood frame, board and batten wood siding, and a cement foundation. There is a large 6 ft. plus spotted horse on top of a sign near the street that says, "Busy Bee Cafe" - in Neon.

This is a neutral structure.

**HISTORICAL SIGNIFICANCE:** Justify how the persons, important events, and/or historical patterns associated with the structure/site and surrounding area lend the property significance.

**INTEGRITY:** Assess the degree to which the structure/site, and surrounding area accurately convey the historical associations of the property.

This recently remodeled commercial building is on a busy thoroughfare. Remodeling has totally hidden the older structure underneath, causing loss of integrity of design and materials.

**INFORMATION VALUE:** Explain how the extant structure/site may demonstrate or yield information about its historic use or construction.

**FORM PREPARED BY:**

Name Elizabeth Wood

Address: Box 12, Roundup, Mt.

Date: July 13, 1983

**GEOGRAPHICAL INFORMATION:**

Acreage: Less than one acre.

USGS Quad: Roundup, Mt.

UTM's: \_\_\_\_\_