

# MONTANA HISTORICAL AND ARCHITECTURAL INVENTORY

Site # \_\_\_\_\_



Legal Description: Block 20, 1/2 Lots 6 & 7, Northwest Townsite, Second Addition  
 Address: 306 4th St. West  
 Ownership: name: Thomas L. Young  
 private  public address: Box 281, Roundup, Mt.

Roll # B3 Frame # 36

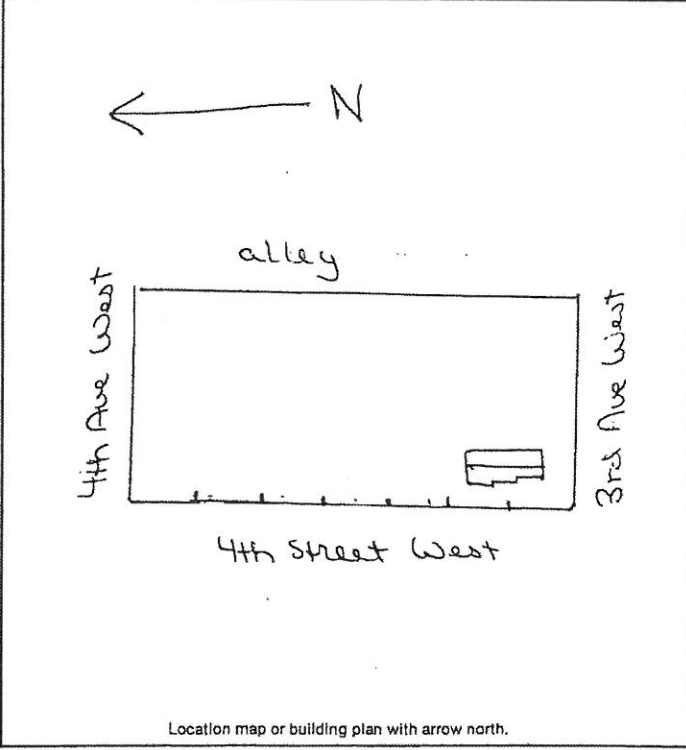

Location map or building plan with arrow north.

Historic Name: \_\_\_\_\_  
 Common Name: \_\_\_\_\_  
 Date of Construction: 1974  estimated  documented  
 Architect: \_\_\_\_\_  
 Builder: \_\_\_\_\_  
 Original Owner: \_\_\_\_\_  
 Original Use: Residence  
 Present Use: Residence

Research Sources:  
 abstract of title  city directories  
 plat records/maps  sewer/water permits  
 tax cards 1974  obituaries  
 building permit  biographies  
 Sanborn maps — dates: \_\_\_\_\_

Bibliography: \_\_\_\_\_

**PHYSICAL DESCRIPTION:** Describe present appearance of structure/site, then contrast and compare that with it's original appearance, noting additions, alterations, and changes in materials. Discuss significant architectural features.

A new, one-story, wood frame residence with gable roof with extending eaves, vertical wood paneled siding (with horizontal board siding on the gable). Windows are aluminum casement with surround trim.

This is a neutral structure.

**HISTORICAL SIGNIFICANCE:** Justify how the persons, important events, and/or historical patterns associated with the structure/site and surrounding area lend the property significance.

**INTEGRITY:** Assess the degree to which the structure/site, and surrounding area accurately convey the historical associations of the property.

This structure is a new building in a block of older, small-medium sized residences. Its scale, design, & materials make it a neutral structure for the area.

**INFORMATION VALUE:** Explain how the extant structure/site may demonstrate or yield information about its historic use or construction.

**FORM PREPARED BY:**

Name William A. Babcock

Address: 2920 Salish Ct., Missoula, Mt.

Date: July 15, 1983

**GEOGRAPHICAL INFORMATION:**

Acreage: Less than one acre

USGS Quad: Roundup, Mt.

UTM's: \_\_\_\_\_