

MONTANA HISTORICAL AND ARCHITECTURAL INVENTORY

Site #



Legal Description: Block 49, Lot 5, Roundup Second Addition

Address: 305 3rd Street West

Ownership: name: W.K. Timberman

private public address: 305 3rd Street West, Roundup, MT

Roll #B3 Frame # 30

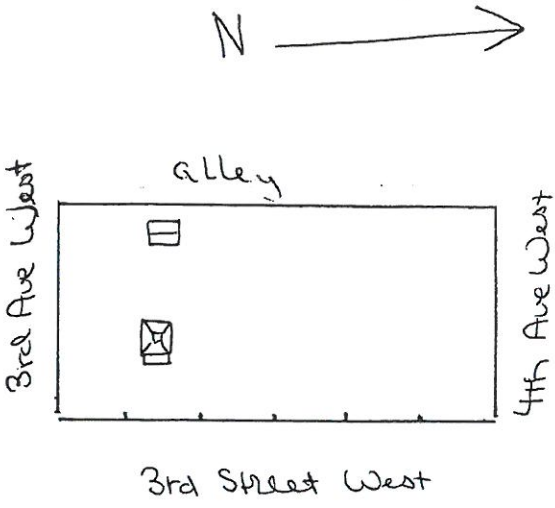

Location map or building plan with arrow north.

Historic Name: _____

Common Name: _____

Date of Construction: before 1920 estimated documented

Architect: _____

Builder: M.M. Klein

Original Owner: M.M. Klein

Original Use: residence

Present Use: residence

Research Sources:

- abstract of title
- plat records/maps
- tax cards 1920
- building permit
- Sanborn maps -- dates: 1920; before
- city directories
- sewer/water permits
- obituaries
- biographies

Bibliography:

Roundup Record 2/28/13
Chain of Ownership cards, Clerk and Recorder's Office

PHYSICAL DESCRIPTION: Describe present appearance of structure/site, then contrast and compare that with it's original appearance, noting additions, alterations, and changes in materials. Discuss significant architectural features.

A one-story, square shaped, wood-framed residence with truncated pyramidal hip roof, front porch, wood shake siding and cinder block foundation. This originally was a log structure. Roof is composition shingle. Front porch is enclosed and has shed roof. Windows are wood-frame, double-hung with wood-surround trim. Front door is wood frame with wood panel and multi lights. A wood frame, gable roof garage with shake siding and metal door is located at rear of property. This is a neutral structure.

HISTORICAL SIGNIFICANCE: Justify how the persons, important events, and/or historical patterns associated with the structure/site and surrounding area lend the property significance.

This structure was constructed in 1913 by Mike Klein for E.L. Hendrix and Charles P. Tillman. It was originally a log bungalow. E.L. Hendrix was president of Hendrix Mercantile Company in the 1910's. C.F. Tillman was superintendent of the Roundup Water Company and head of C.F. Tillman Company, plumbing, steam and hot water heating. Both were subsequently owners of this property.

Sources: Roundup Record 2/28/13
Polk City Directory 1912-13
Chain of Ownership Cards

INTEGRITY: Assess the degree to which the structure/site, and surrounding area accurately convey the historical associations of the property. **Residence is located in block with other older residences, although of smaller scale. This originally was a log structure to which shake siding was later added, with a significant loss of integrity design and materials.**

INFORMATION VALUE: Explain how the extant structure/site may demonstrate or yield information about its historic use or construction.

FORM PREPARED BY:

Name: William A. Babcock
Address: 2920 Salish Court, Missoula, MT
Date: 7/15/83

GEOGRAPHICAL INFORMATION:

Acreage: less than one acre
USGS Quad: Roundup, MT
UTM's: _____