

MONTANA HISTORICAL AND ARCHITECTURAL INVENTORY

Site # _____



Legal Description: Block 1, Lots 20 - 22, Nelson ^(add) Addition

Address: 223 1st Ave. West

Ownership: name: Leroy Newton

private public address: 223 1st Ave. West, Roundup, Mt.

Roll # A3 Frame # 11

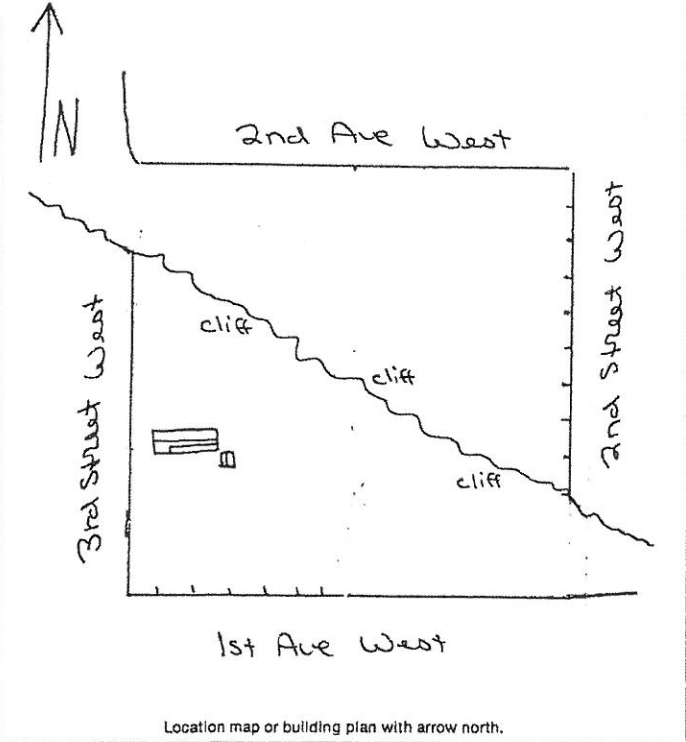

Location map or building plan with arrow north.

Historic Name: _____

Common Name: _____

Date of Construction: Moved in 1955 approx. estimated documented
Remodeled 1960

Architect: _____

Builder: _____

Original Owner: Siegfried and Florian Soennichson

(at this site)

Original Use: Row house apartments

Present Use: Duplex - residence

- Research Sources:
- abstract of title
 - plat records/maps
 - tax cards
 - building permit
 - Sanborn maps — dates: _____
 - city directories
 - sewer/water permits
 - obituaries
 - biographies

Bibliography:
Interview: Mrs. Florian Soennichson 8/10/83
Chain of Ownership cards, Clerk and Recorder's Office

PHYSICAL DESCRIPTION: Describe present appearance of structure/site, then contrast and compare that with it's original appearance, noting additions, alterations, and changes in materials. Discuss significant architectural features.

This long, wood-frame, one-story rectangular duplex has a gable roof with a recessed porch under the eaves. Other features include: asphalt roof shingles, masonite siding, 1/1 double-hung windows. The porch is a raised wood plank porch with no support posts, and there are several wood doors. The west end of the building is a garage with rising wood and glass panel door.

There is a dented, crumbling tar paper storage shed with gable roof to the east. This is a neutral structure.

HISTORICAL SIGNIFICANCE: Justify how the persons, important events, and/or historical patterns associated with the structure/site and surrounding area lend the property significance.

INTEGRITY: Assess the degree to which the structure/site, and surrounding area accurately convey the historical associations of the property.

This structure is at the back of a commercial thoroughfare where many older houses have recently been razed and burned. This old (1920) row house apartment building was moved here about 1955 from across town. It is a neutral structure due to loss of integrity of location.

INFORMATION VALUE: Explain how the extant structure/site may demonstrate or yield information about its historic use or construction.

FORM PREPARED BY:

Name Elizabeth Wood

Address: Box 12, Roundup, Mt.

Date: July 9, 1983

GEOGRAPHICAL INFORMATION:

Acreage: Less than one acre.

USGS Quad: Roundup, Mt.

UTM's: _____