

MONTANA HISTORICAL AND ARCHITECTURAL INVENTORY

Site #	
Legal Description: Block 1, Lots 20 - 22, Nelson Second Addition	
Address: 221 1st Ave. West	
Ownership: name: Leroy Newton	
<input checked="" type="checkbox"/> private <input type="checkbox"/> public address: 223 1st Ave. West, Roundup, Mt.	Roll # A3 Frame # 10

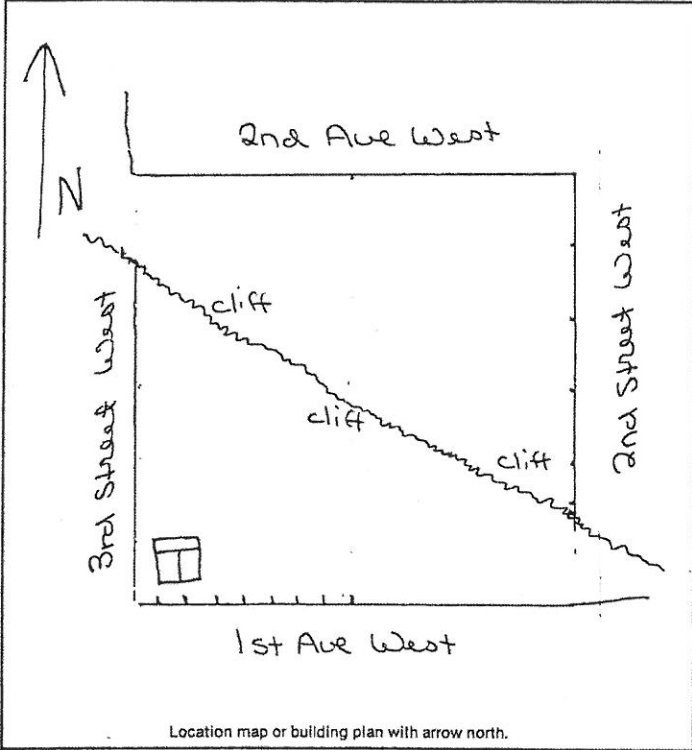

Historic Name: _____
Common Name: _____
Date of Construction: <u>Moved in after 1950</u> <input checked="" type="checkbox"/> estimated <u>Remodeled - 1957</u> <input type="checkbox"/> documented
Architect: _____
Builder: _____
Original Owner: <u>Griegfried and Florian Soennichson</u> <u>(at this site)</u>
Original Use: <u>Residence</u>
Present Use: <u>Vacant residence</u>
Research Sources:
<input type="checkbox"/> abstract of title <input type="checkbox"/> plat records/maps <input checked="" type="checkbox"/> tax cards 1920 <input type="checkbox"/> building permit <input type="checkbox"/> Sanborn maps — dates: _____ <input type="checkbox"/> city directories <input type="checkbox"/> sewer/water permits <input type="checkbox"/> obituaries <input type="checkbox"/> biographies
Bibliography:
<u>Interview: Mrs. Florian Soennichson 8/10/83</u> <u>Chain of Ownership cards, Clerk and Recorder's Office</u>

PHYSICAL DESCRIPTION: Describe present appearance of structure/site, then contrast and compare that with it's original appearance, noting additions, alterations, and changes in materials. Discuss significant architectural features.

This 1¼-story square, wood-frame residence has two intersecting gable roofs. Other features include blue asphalt shingles, gray masonite siding, and a raised concrete foundation with fixed windows. Also included are a small 1/1 double-hung window in the gable, 2 oversized rectangular windows with 4-light side windows, metal slate curved awnings over old windows and a huge concrete stoop with steps and iron bar railing.

This is a neutral structure.

HISTORICAL SIGNIFICANCE: Justify how the persons, important events, and/or historical patterns associated with the structure/site and surrounding area lend the property significance.

INTEGRITY: Assess the degree to which the structure/site, and surrounding area accurately convey the historical associations of the property.

This old house is on a mixed commercial/residential busy thoroughfare. It was moved into the area after 1950 and has been remodeled since then, which has caused a loss of integrity of location and materials.

INFORMATION VALUE: Explain how the extant structure/site may demonstrate or yield information about its historic use or construction.

FORM PREPARED BY:

Name Elizabeth Wood

Address: Box 12, Roundup, Mt.

Date: July 9, 1983

GEOGRAPHICAL INFORMATION:

Acreage: Less than one acre.

USGS Quad: Roundup, Mt.

UTM's: _____