

# MONTANA HISTORICAL AND ARCHITECTURAL INVENTORY

Site #



Legal Description: Block 50, S 50' of N 100', Roundup Second Addition

Address: 219 Third Street West

Ownership: name: Bess Matzke & Alice A. Graves & Thomas L. Liggett

private  public address: 219 Third Street West, Roundup, Mt.

Roll # A3 Frame # 26

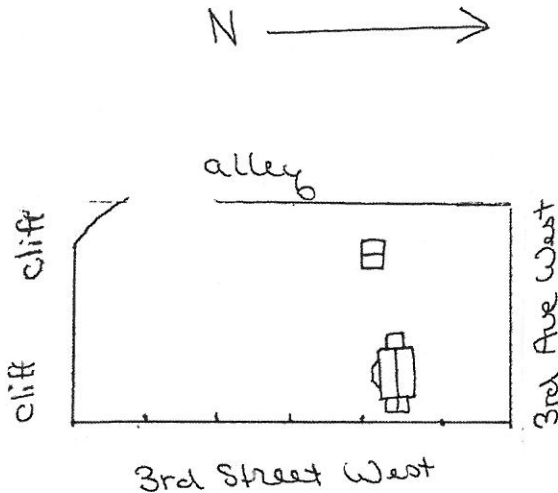

Location map or building plan with arrow north.

Historic Name: \_\_\_\_\_

Common Name: \_\_\_\_\_

Date of Construction: 1915  estimated  documented

Architect: \_\_\_\_\_

Builder: \_\_\_\_\_

Original Owner: C.F. Richardson (probably)

Original Use: residence

Present Use: Residence

Research Sources:

- abstract of title
- plat records/maps
- tax cards
- building permit
- city directories
- sewer/water permits
- obituaries
- biographies

Sanborn maps — dates: 1912, 1920, before 1912 - 1920

Bibliography:

Chain of Ownership cards, Clerk and Recorder's Office

**PHYSICAL DESCRIPTION:** Describe present appearance of structure/site, then contrast and compare that with it's original appearance, noting additions, alterations, and changes in materials. Discuss significant architectural features.

This smaller rectangular one-story wood frame residence has a broad gable roof, one bay with hip roof, an enclosed gable roof front porch, and a small shed roof addition to the rear. Other features include stretcher board interior brick chimney, very elongated eaves with exposed rafters, multilight 1/1 double-hung windows, a south facing bay window with multilight 1/1 double-hung windows, cedar shingle gable ends, diagonal braces and purlins, wood overlap siding with corner boards. The enclosed gable porch is raised (cement step) and has large fixed rectangular row windows with rectangular transoms above. There is no visible foundation. Modern materials include asphalt roof shingles and masonite exterior wainscoting, slightly flared to create a "skirt" effect.

Architecturally significant is the skirted exterior wainscoting, multilight windows and broad gable roof.

This is a contributing structure.

**HISTORICAL SIGNIFICANCE:** Justify how the persons, important events, and/or historical patterns associated with the structure/site and surrounding area lend the property significance.

C.F. Richardscn owned this property from 1914-1919. He was a cashier at Citizens State Bank from 1910-1915. He was Roundup City Treasurer, 1912-13, and became Vice President of Citizens State Bank (1916-18).

Henry M. Frohn bought the house in 1919. He was a clerk for F.M. Wall Co., 1916-18.

Source: Polk City Directory

**INTEGRITY:** Assess the degree to which the structure/site, and surrounding area accurately convey the historical associations of the property.

This house is located in an upper middle class residential neighborhood. This house has slight loss of materials integrity due to the masonite "skirt" siding, but retains good craftsmanship (multilight windows, braces and purlins) and design (bay window, enclosed gable porch) integrity.

**INFORMATION VALUE:** Explain how the extant structure/site may demonstrate or yield information about its historic use or construction.

**FORM PREPARED BY:**

Name: Elizabeth Wood

Address: Box 12, Roundup, Mt.

Date: July 13, 1983

**GEOGRAPHICAL INFORMATION:**

Acreage: Less than one acre.

USGS Quad: Roundup, Mt.

UTM's: \_\_\_\_\_