

MONTANA HISTORICAL AND ARCHITECTURAL INVENTORY

Site # _____



Roll # B2 Frame # 19

Legal Description: Block 1, Lots 9 & 10, Nelson Addition
 Address: 218 1st Ave. West
 Ownership: name: Donna Marie & Marko J. Vranish
 private address: 218 1st Ave. West, Roundup, Mt.
 public

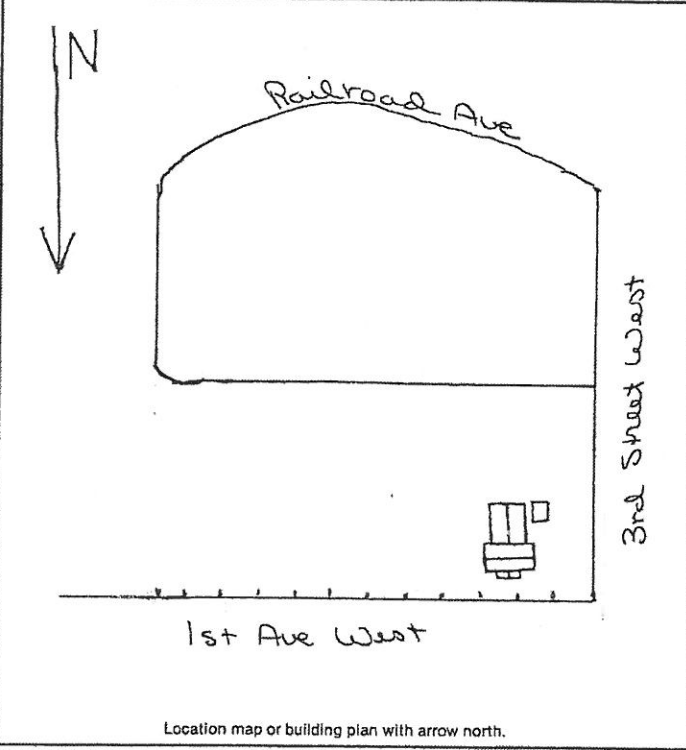

Historic Name: _____
 Common Name: _____
 Date of Construction: Before 1920 estimated documented
 Architect: _____
 Builder: _____
 Original Owner: John Roe
 Original Use: Residence
 Present Use: Residence

Research Sources:

<input type="checkbox"/> abstract of title	<input type="checkbox"/> city directories
<input type="checkbox"/> plat records/maps	<input type="checkbox"/> sewer/water permits
<input checked="" type="checkbox"/> tax cards 1905	<input type="checkbox"/> obituaries
<input type="checkbox"/> building permit	<input type="checkbox"/> biographies

Sanborn maps — dates: 1912, 1920; before 1920
 Bibliography: Ave. not included on 1912 map
 Chain of Ownership Cards, Clerk and Recorder's Office

PHYSICAL DESCRIPTION: Describe present appearance of structure/site, then contrast and compare that with it's original appearance, noting additions, alterations, and changes in materials. Discuss significant architectural features.

A one-story, rectangular-shaped residence with intersecting crossing gables, composition shingle siding, and concrete over cinder block foundation. Roof is wood shingle & has interior brick chimney. Windows on main part of residence are wood frame, double hung with wood-surround trim. Front-facing gable roof covers projecting enclosed porch with fixed wood-frame, multi light windows, and coursed, fock-faced brick of varying lengths. Front porch extension has concrete front steps with iron railing. Rear of structure has shed roof addition. A one-story, gable-roof two car garage located to the side of the residence has two large sliding doors with vertical siding and outside mounted rail & rollers. Garage has horizontal wood siding and wood-shingle roof.

This is a neutral structure.

HISTORICAL SIGNIFICANCE: Justify how the persons, important events, and/or historical patterns associated with the structure/site and surrounding area lend the property significance.

John Roe was a miner at the Roundup Coal Mine No. 3 in 1912, a trackman for the No. 3 mine in 1914, a teamster for Meagher Brothers (1916).

Source: Polk City Directories
Chain of Ownership Cards

INTEGRITY: Assess the degree to which the structure/site, and surrounding area accurately convey the historical associations of the property.

Structure is located in block with other small older residences along main highway into town. Addition of large front porch and rear shed roof extension has caused some loss of integrity of design. Use of composition shakes on structure and rock faced apron on enclosed front porch have caused loss of integrity of materials.

INFORMATION VALUE: Explain how the extant structure/site may demonstrate or yield information about its historic use or construction.

FORM PREPARED BY:

Name William Babcock
Address: 2920 Salish Ct., Missoula, Mt.
Date: July 11, 1983

GEOGRAPHICAL INFORMATION:

Acreage: Less than one acre
USGS Quad: Roundup, Mt.
UTM's: _____