

MONTANA HISTORICAL AND ARCHITECTURAL INVENTORY

Site #



Roll # A3 Frame # 25

Legal Description: Block 50, S 50' of N 150', Roundup Second Addition
 Address: 215 Third Street West
 Ownership: name: Emil. Jr. & Lorene V. Zimmerman
 private public address: 215 Third Street West, Roundup, Mt.

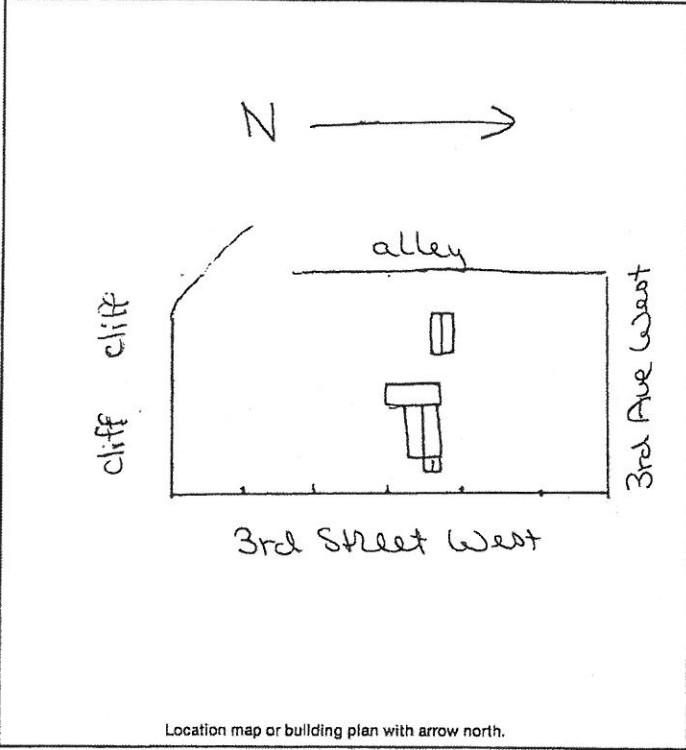

Location map or building plan with arrow north.

Historic Name: _____
 Common Name: _____
 Date of Construction: Between 1912 - 1920 estimated documented
 Architect: _____
 Builder: _____
 Original Owner: Floyd Dye
 Original Use: Residence
 Present Use: Residence

- Research Sources:
- abstract of title
 - plat records/maps
 - tax cards 1920
 - building permit
 - Sanborn maps — dates: 1912, 1920, between 1912 - 1920
 - city directories
 - sewer/water permits
 - obituaries
 - biographies

Bibliography:
 Chain of Ownership cards, Clerk and Recorder's Office
 Interview: Emil Zimmerman 7/12/83

PHYSICAL DESCRIPTION: Describe present appearance of structure/site, then contrast and compare that with it's original appearance, noting additions, alterations, and changes in materials. Discuss significant architectural features.

This one-story wood frame rectangular residence has a gable roof, an enclosed gable roof one-half front porch, and an open covered deck to the rear. Other features include interior brick chimney, extended eaves with purlins and exposed rafters, windows in wood surround, 1/1 row windows in the enclosed porch, and a cement foundation. Modern materials include masonite siding and asphalt roof shingles.

To the back is a rectangular gable roof garage with exposed rafters, asphalt roof shingles, beveled edge siding with corner boards on a tall (3½ foot) bare cement foundation.

Architecturally significant is the purlins, and gable end decoration.
 This is a contributing structure.

HISTORICAL SIGNIFICANCE: Justify how the persons, important events, and/or historical patterns associated with the structure/site and surrounding area lend the property significance.

INTEGRITY: Assess the degree to which the structure/site, and surrounding area accurately convey the historical associations of the property.

This house is located in an upper middle class residential area. This house has some loss of integrity of materials due to the addition of masonite siding and asphalt shingles, but retains integrity of design (gable roof with enclosed entry) and craftsmanship (gable end decoration, purlins).

INFORMATION VALUE: Explain how the extant structure/site may demonstrate or yield information about its historic use or construction.

FORM PREPARED BY:

Name: Elizabeth Wood
Address: Box 12, Roundup, Mt.
Date: July 12, 1983

GEOGRAPHICAL INFORMATION:

Acreage: Less than one acre.
USGS Quad: Roundup, Mt.
UTM's: _____