

MONTANA HISTORICAL AND ARCHITECTURAL INVENTORY

Site # _____



Roll # A5 Frame # 23

Legal Description: Block 50, N 50' of S 100', Roundup Second Additon
 Address: 205 Third Street West
 Ownership: name: James H. and Charlotte A. Sibley
 private address: 205 Third Street West, Roundup, MT
 public

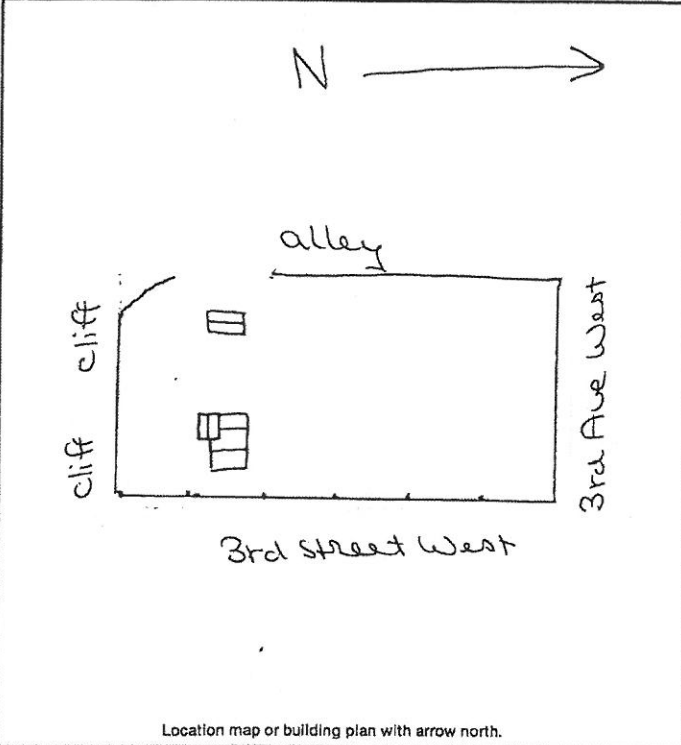

Location map or building plan with arrow north.

Historic Name: _____
 Common Name: _____
 Date of Construction: 1912 estimated documented
 Architect: _____
 Builder: W.R. Evans
 Original Owner: V.D. Dusenberry
 Original Use: residence
 Present Use: residence

Research Sources:
 abstract of title city directories
 plat records/maps sewer/water permits
 tax cards obituaries
 building permit biographies
 Sanborn maps — dates: 1912, 1920; before 1920

Bibliography: not mapped, 1912
Chain of Ownership cards, Clerk and Recorder's Office
 Interview: Annie Larsen July, 1983

PHYSICAL DESCRIPTION: Describe present appearance of structure/site, then contrast and compare that with it's original appearance, noting additions, alterations, and changes in materials. Discuss significant architectural features.

This $1\frac{1}{2}$ story wood frame residence has a gable roof with a large shed roof dormer facing the street and rear additions with shed and gable roofs. Other features include: Exposed rafters; 1/1 double hung and multilight double hung windows and an enclosed full front porch recessed under the eaves. There is a cement foundation. Modern materials include: asphalt roof shingles; aluminum siding; 3 panel aluminum frame windows in the enclosed porch; 1/1 slide aluminum gable windows; and louvered decorative shutters. To the rear is a vertical wood panel double garage with gable roof, cement foundation and rising 3 light wood panel garage door.

The architectural feature that gives this house character is the street facing front dormer.

This is a contributing structure.

HISTORICAL SIGNIFICANCE: Justify how the persons, important events, and/or historical patterns associated with the structure/site and surrounding area lend the property significance.

Verne Duseberry was a lawyer, originally partners with William Jameson (City Clerk, U.S. Commissioner) on Main Street (1912-1915), then later partners with Thomas Matthews (city attorney), 1918. He owned this property from 1911 to 1925.

Source: Polk City Directories
Chain of Ownership Cards

INTEGRITY: Assess the degree to which the structure/site, and surrounding area accurately convey the historical associations of the property.

This house is located in an upper middle class residential neighborhood. This house has lost integrity of materials due to the addition of aluminum siding and the remodeled front porch windows. However, integrity of craftsmanship and design are still retained with the gable roof shape, shed roof dormers, and recessed front porch.

INFORMATION VALUE: Explain how the extant structure/site may demonstrate or yield information about its historic use or construction.

FORM PREPARED BY:

Name Elizabeth Wood

Address: Box 12, Roundup

Date: July 12, 1983

GEOGRAPHICAL INFORMATION:

Acreage: less than 1 acre

USGS Quad: Roundup, MT

UTM's: _____