

MONTANA HISTORICAL AND ARCHITECTURAL INVENTORY

Site #



Legal Description: Block 6 Lot 7, Steen Addition

Address: 204 Seventh Street West

Ownership: name: Carolyn Sue Krum and Margaret Ann Caster

private public address: 204 Seventh Street West Roundup, MT

Roll # A4 Frame # 29

← N

6th Street West

3rd Ave West

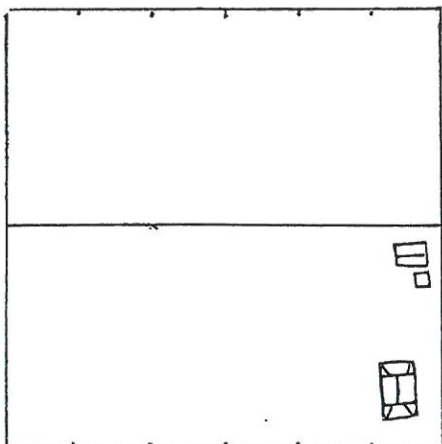

2nd Ave West

7th Street West

Location map or building plan with arrow north.

Historic Name: _____

Common Name: _____

Date of Construction: 1920 Remodeled 1967 estimated documented

Architect: _____

Builder: _____

Original Owner: _____

Original Use: residence

Present Use: residence

Research Sources:

- abstract of title
- plat records/maps
- tax cards
- building permit
- Sanborn maps — dates: area not mapped 1912 or 1920
- city directories
- sewer/water permits
- obituaries
- biographies

Bibliography:

Chain of Ownership cards, Clerk and Recorder's Office

PHYSICAL DESCRIPTION: Describe present appearance of structure/site, then contrast and compare that with it's original appearance, noting additions, alterations, and changes in materials. Discuss significant architectural features.

This one story wood frame rectangular residence has a gable roof, a tall hip roof enclosed 7/8 front porch and a hip roof rear addition. Other features include an interior brick chimney, exposed rafters, diagonal braces with purling and decorative wood work in the gable corners, 1/1 double hung windows in wood surround. The front porch is sealed, with all the windows covered with plywood except two, and there is a light wood front door with storm door. There is a cement foundation. New materials include the plywood in the front porch, new cement stoop with two steps, and masonite siding. Outbuildings include: 1. rectangular wood frame garage with gable roof, wood roof shingles, overlap siding with corner boards, and casement double garage doors of vertical wood siding, no foundation. 2. A shed roof part open shed with vertical board siding and asphalt roofing. 3. Old outhouse with asphalt gable roof, horizontal board siding, and half moon cut in wall.

This is a **contributing structure.**

HISTORICAL SIGNIFICANCE: Justify how the persons, important events, and/or historical patterns associated with the structure/site and surrounding area lend the property significance.

INTEGRITY: Assess the degree to which the structure/site, and surrounding area accurately convey the historical associations of the property.

This house is located on the edge of town across the street from a large horse pasture. The neighborhood is a mix of old and extensively remodeled homes. Boarding up the front porch and the masonite siding, has caused some loss of design and materials integrity. Basic design and craftsmanship integrity is still retained.

INFORMATION VALUE: Explain how the extant structure/site may demonstrate or yield information about its historic use or construction.

FORM PREPARED BY:

Name Elizabeth Wood

Address Box 112, Roundup

Date July 16, 1983

GEOGRAPHICAL INFORMATION:

Acreage: Less than 1 acre

USGS Quad: Roundup

UTM's: _____