

# MONTANA HISTORICAL AND ARCHITECTURAL INVENTORY

Site #



Legal Description: Block 1, Lots 13-16, Nelson Addition

Address: 16 Third Street West

Ownership: name: Pete Kowalski

private  
 public address: 16 Third Street West, Roundup, MT

Roll # B2 Frame # 20

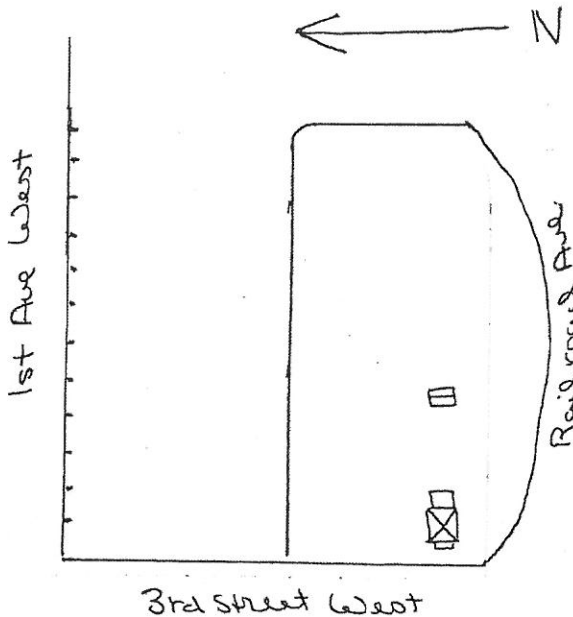

Location map or building plan with arrow north.

Historic Name: \_\_\_\_\_

Common Name: \_\_\_\_\_

Date of Construction: 1920  estimated  documented

Architect: \_\_\_\_\_

Builder: \_\_\_\_\_

Original Owner: \_\_\_\_\_

Original Use: residence

Present Use: residence

Research Sources:

<input type="checkbox"/> abstract of title	<input type="checkbox"/> city directories
<input type="checkbox"/> plat records/maps	<input type="checkbox"/> sewer/water permits
<input checked="" type="checkbox"/> tax cards	<input type="checkbox"/> obituaries
<input type="checkbox"/> building permit	<input type="checkbox"/> biographies
<input type="checkbox"/> Sanborn maps — dates: <u>area not included on 1912</u>	

Bibliography: \_\_\_\_\_ or 1920 maps

Chain of Ownership cards, Clerk and Recorder's Office

**PHYSICAL DESCRIPTION:** Describe present appearance of structure/site, then contrast and compare that with it's original appearance, noting additions, alterations, and changes in materials. Discuss significant architectural features.

A one-story, square, wood frame residence with pyramidal hip roof, clapboard siding, and concrete foundation. Roof has center brick chimney and wood shingle roof with crown molding. Front porch has shed roof, screens, and clapboard apron. A shed roof extension is located to the rear of the residence. Windows vary: large multi-frame fixed window with sliding side windows has wood trim. Smaller wood frame 1/1 double hung window is located on one side of residence. Front door is wood with small lights, wood frame, and wood surrounding trim.

This is a contributing structure.

**HISTORICAL SIGNIFICANCE:** Justify how the persons, important events, and/or historical patterns associated with the structure/site and surrounding area lend the property significance.

**INTEGRITY:** Assess the degree to which the structure/site, and surrounding area accurately convey the historical associations of the property.

The residence is located in a block of other old smaller homes. The deteriorated condition of the front porch, additional large aluminum window have caused some loss of integrity, but basic design and original materials are still evident.

**INFORMATION VALUE:** Explain how the extant structure/site may demonstrate or yield information about its historic use or construction.

**FORM PREPARED BY:**

Name: William Babcock

Address: 2920 Salish Court, Missoula, MT

Date: July 11, 1983

**GEOGRAPHICAL INFORMATION:**

Acreage: less than one acre

USGS Quad: Roundup, MT

UTM's: \_\_\_\_\_