

# MONTANA HISTORICAL AND ARCHITECTURAL INVENTORY

Site #	
Legal Description: Block 1, Lots 1 & 2, Nelson Second Addition	
Address: 123 Second Street West	
Ownership: name: Allan and Linda Blessing	
<input checked="" type="checkbox"/> private <input type="checkbox"/> public address: 123 Second Street West, Roundup, MT	Roll # A 3 Frame # 5

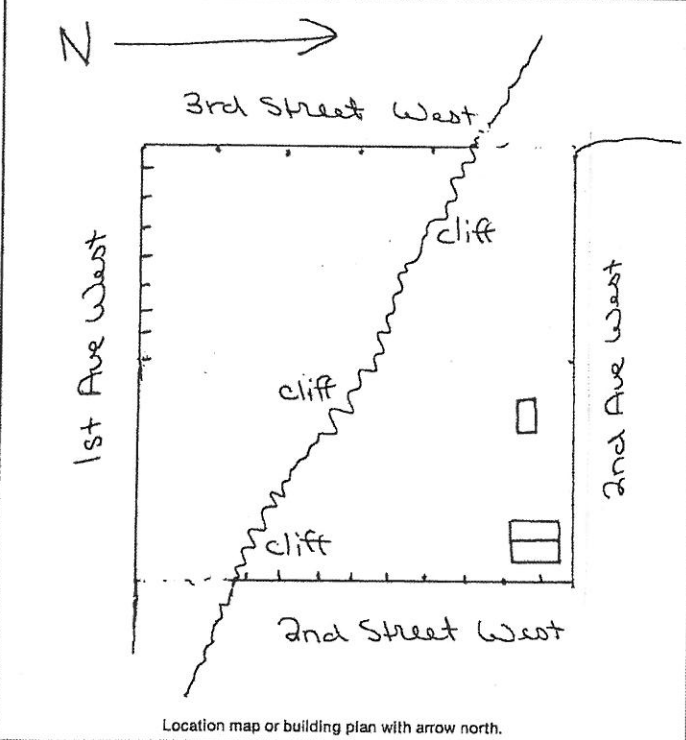

Historic Name:
Common Name:
Date of Construction: <u>between 1912 &amp; 1920</u> <input type="checkbox"/> estimated <input checked="" type="checkbox"/> documented
Architect:
Builder: <u>Alfred Shaw</u>
Original Owner: <u>Alfred Shaw</u>
Original Use: <u>residence</u>
Present Use: <u>residence</u>
Research Sources:
<input type="checkbox"/> abstract of title <input type="checkbox"/> plat records/maps <input checked="" type="checkbox"/> tax cards <u>1912</u> <input type="checkbox"/> building permit <input checked="" type="checkbox"/> Sanborn maps — dates: <u>1912, 1920; between 1912-1920</u>
<input checked="" type="checkbox"/> city directories <input type="checkbox"/> sewer/water permits <input type="checkbox"/> obituaries <input type="checkbox"/> biographies
Bibliography: <u>Chain of Ownership cards, Clerk and Recorder's Office</u>

**PHYSICAL DESCRIPTION:** Describe present appearance of structure/site, then contrast and compare that with it's original appearance, noting additions, alterations, and changes in materials. Discuss significant architectural features.

This large 1½ story square wood frame residence has a steep pitched gable roof, large shed roof dormers and an enclosed under eaves front porch. Other features include: extended eaves; exposed rafters; diagonal braces and purlins; a large interior brick stretcher bond chimney; gable end eaves; decoration of wood collar beam and king post; horizontal overlap wood siding; diamond pattern miltilight over 1, double hung rectangular windows with molded trim wood surround. Dormer windows are 3/3 double hung, all the windows on the first floor have extended sills, and the exterior wainscoting is wood shingles. The cement foundation has 2/2 tilt windows in it. The enclosed screened porch has molded wood corner posts. Modern materials include asphalt roof shingles and an interior metal stove pipe chimney.

There is a tiny round arched roof metal garage in back with corrugated metal double doors, metal roof and sides. No foundation.

This is a primary structure.

**HISTORICAL SIGNIFICANCE:** Justify how the persons, important events, and/or historical patterns associated with the structure/site and surrounding area lend the property significance.

This structure is significant because it was designed and constructed by, and was the residence of, Alfred Shaw, General Manager of A. Shaw and Company, Shelf and Heavy Hardware and Lumber, an important building trades company in early Roundup. Shaw's hardware and lumber company was located in Block 8, Roundup Original Townsite. The hardware store, constructed in 1916, is the present City Fire Station.

The manner in which this house was designed was typical of the way many houses were constructed in early Roundup. Alfred W. Eiselein, editor and publisher of the Roundup Record, claimed that Shaw drew the plans for the residence on the head of a barrel of nails. This may have been true, since it alleged that part of the front porch roof had to be removed to get the front door open.

Sources: Roundup Record 1/5/17  
Polk City Directories  
Sanborn Map, 1920  
Interview: Annie Larsen and Louise Rasmussen 8/10/83

**INTEGRITY:** Assess the degree to which the structure/site, and surrounding area accurately convey the historical associations of the property.

This house is located in an upper middle class residential neighborhood. This house has excellent integrity of design (recessed porch, dormers) and craftsmanship (diagonal braces and purlins, king post and collar beam) and has some slight loss of integrity of materials due to the asphalt roof shingles.

**INFORMATION VALUE:** Explain how the extant structure/site may demonstrate or yield information about its historic use or construction.

**FORM PREPARED BY:**

Name Elizabeth Wood/William Babcock

Address: Box 12, Roundup

Date: July 11, 1983

**GEOGRAPHICAL INFORMATION:**

Acreage: less than 1 acre

USGS Quad: Roundup, Montana

UTM's: \_\_\_\_\_