

MONTANA HISTORICAL AND ARCHITECTURAL INVENTORY

Site # _____



Roll # B3 Frame # 20

Legal Description: Block 2, Lot 12, Park Addition

Address: 120 6th St. West

Ownership: name: Anton J. Lekse, Jr.

private public address: 120 6th St. West, Roundup, Mt.

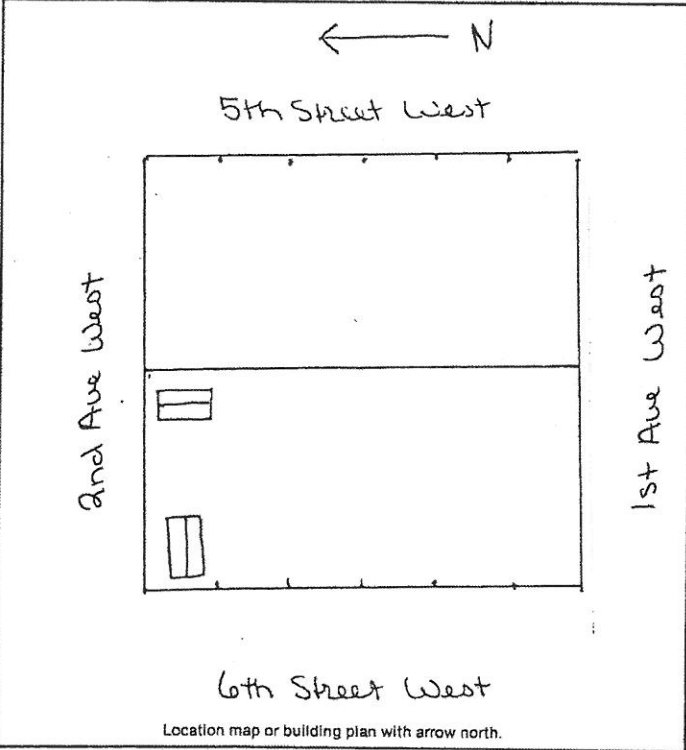

Historic Name: _____

Common Name: Moved to present site, 1938-39 estimated documented

Date of Construction: 1920 estimated documented

Remodeled 1971

Architect: _____

Builder: _____

Original Owner: _____

Original Use: Residence

Present Use: Residence

Research Sources:

<input type="checkbox"/> abstract of title	<input type="checkbox"/> city directories
<input type="checkbox"/> plat records/maps	<input type="checkbox"/> sewer/water permits
<input checked="" type="checkbox"/> tax cards	<input type="checkbox"/> obituaries
<input type="checkbox"/> building permit	<input type="checkbox"/> biographies

Sanborn maps — dates: 1920

Bibliography:

Interview: Anton Lekse, Jr. 7/14/83

Chain of Ownership cards, Clerk and Recorder's Office

PHYSICAL DESCRIPTION: Describe present appearance of structure/site, then contrast and compare that with it's original appearance, noting additions, alterations, and changes in materials. Discuss significant architectural features.

A one and one-half story, rectangular wood frame structure with gable roof, horizontal aluminum siding, and concrete foundation. Roof has interior brick chimney, composition singles, and front extending eaves with fascia. Building has sliding aluminum cased windows set inside of wood frames. Door is wood with single light and wood frame. A large wood frame, gable roof shed with metal roof and metal siding is located at the rear of the property.

Aluminumsiding and windows were added in 1971.

Structure is neutral, for inclusion in a potential historic district.

HISTORICAL SIGNIFICANCE: Justify how the persons, important events, and/or historical patterns associated with the structure/site and surrounding area lend the property significance.

This residence was formerly used as a residence for Milwaukee Railroad personnel in Geneva, about 21 miles east of Roundup. It was moved to present location in 1938-39.

Source: Interview: Anton Lekse 7/14/83

INTEGRITY: Assess the degree to which the structure/site, and surrounding area accurately convey the historical associations of the property.

This residence is located in a block of small, older residences. It is slightly larger than the other structures.

It maintains basic integrity of design, but has lost some integrity of materials with addition of aluminum siding & windows, and integrity of setting because of the large metal residence garage, residence at rear of property. Structure was moved to present location during historical period.

INFORMATION VALUE: Explain how the extant structure/site may demonstrate or yield information about its historic use or construction.

FORM PREPARED BY:

Name William Babcock

Address: 2920 Selish Ct., Missoula, Mt.

Date: July 14, 1983

GEOGRAPHICAL INFORMATION:

Acreage: Less than one acre

USGS Quad: Roundup, Mt.

UTM's: