

MONTANA HISTORICAL AND ARCHITECTURAL INVENTORY

Site # _____

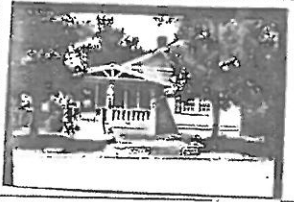

Roll # A3 Frame # 6

Legal Description: Block 1, Lots 3 & 4, Nelson Second Addition

Address: 115 Second Street West

Ownership: name: Lester A. Osborne et ux

private public address: 115 Second Street West, Roundup, MT

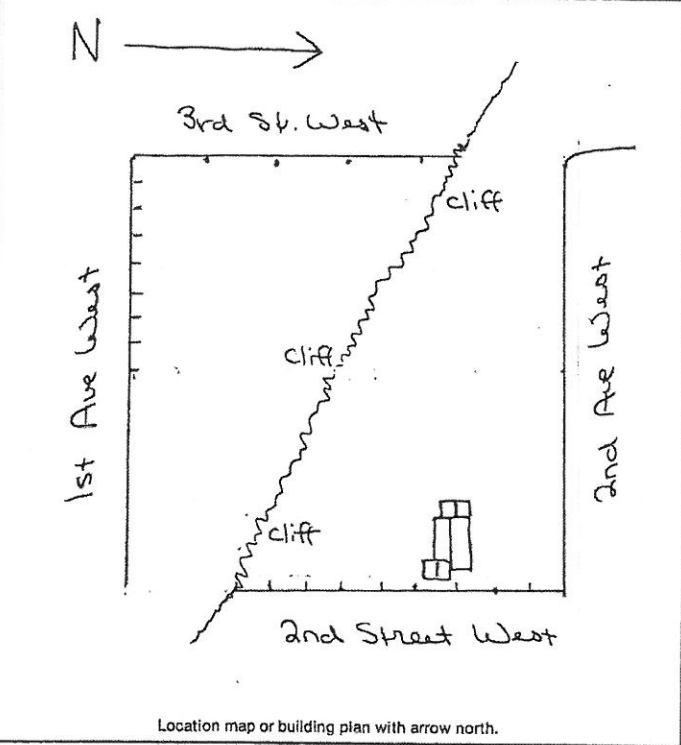

Location map or building plan with arrow north.

Historic Name: _____

Common Name: _____

Date of Construction: 1915 estimated documented

Architect: _____

Builder: _____

Original Owner: Guy O'Neil

Original Use: residence

Present Use: residence

Research Sources:

- abstract of title
- plat records/maps
- tax cards 1910
- building permit
- Sanborn maps — dates: 1912, 1920; between 1912-20
- city directories
- sewer/water permits
- obituaries
- biographies

Bibliography:

Interview: Mrs. Lester Osborne 7/11/83
Chain of Ownership cards, Clerk and Recorder's Office

PHYSICAL DESCRIPTION: Describe present appearance of structure/site, then contrast and compare that with it's original appearance, noting additions, alterations, and changes in materials. Discuss significant architectural features.

This 1 1/2 story square wood frame residence has a gentle pitched gable roof with a gable roof enclosed front porch and a gable roof back addition. Other features include: wood shingle roof with 2 interior chimneys, both stretcher bond brick with corbeled caps; exposed rafters; gable 1/1 double hung windows; very extended eaves, with wood collar beam; king post and diagonal supports; diagonal wood braces with purlins; 6/6 double hung windows with drip board and extended sills; fixed, louvered shutters beside the first floor windows; and horizontal wood overlap siding. The enclosed front porch has molded wood corner posts, wood gable decoration of collar beam, king post and diagonal supports, solid wood panel rails, with lattice work under the porch. The porch is screened. There is a rusticated cement block foundation. The rear gable addition was added later.

This is a contributing structure.

HISTORICAL SIGNIFICANCE: Justify how the persons, important events, and/or historical patterns associated with the structure/site and surrounding area lend the property significance.

This structure was the residence of Dr. Guy E. O'Neil, one of the first dentists in Roundup, who had his practice at 119 Main Street for several years. He owned this property from 1912 to 1919.

Sources: Roundup Record, 12/6/12.

City Directories

Interview: Annie Larsen and Louise Rasmussen 8/10/83

Chain of Ownership cards

INTEGRITY: Assess the degree to which the structure/site, and surrounding area accurately convey the historical associations of the property.

This house is located on a cul-de-sac in an upper middle class neighborhood. This building retains good integrity of design (gable roof, enclosed gable front porch), materials (overlap siding, solid panel rails) and craftsmanship (braces, purlins, collar beam, king post).

INFORMATION VALUE: Explain how the extant structure/site may demonstrate or yield information about its historic use or construction.

FORM PREPARED BY:

Name: Elizabeth Wood/William Babcock

Address: Box 12, Roundup

Date: July 11, 1983

GEOGRAPHICAL INFORMATION:

Acreage: less than 1 acre

USGS Quad: Roundup

UTM's: _____